

# DTEN Guide

## DTEN Smart Connect (BYOD)

June 2024





What is DTEN Smart Connect- BYOD ?

Use Cases

System I/O Connections

BYOD Setting on ZDM

DTEN Systems Support Smart Connect (BYOD)

The experience on each platform

Q&A





## DTEN Smart Connect (BYOD)

**Versatility:** DTEN Smart Connect offers the best user experience with multiple Smart Connect BYOD modes. Whether your team members want to use the DTEN system as a peripheral or screen sharing, they can easily connect and collaborate. Users can connect a laptop (PC or MAC) to a DTEN system and access the camera, microphone, speaker, and touch (D7X & ME Pro) systems as peripherals.

**Charging Capability:** DTEN Smart Connect is the BYOD solution also provides charging capability, ensuring that devices stay powered throughout the meeting.

**Simplicity:** Setting up a video conference becomes a breeze with just a single cable. No more tangled wires or complex setups.





## Use Case 1

Experience seamless collaboration in any meeting room with DTEN's all-in-one collaboration solution. With the flexibility to use any meeting platform you prefer, you can start meetings on your personal laptop and utilize DTEN's state-of-the-art camera, microphone, speaker, and touch features to enhance your overall meeting experience.

DTEN's hardware capabilities are second to none, ensuring that you can enjoy reliable, high-quality audio and video during your meetings. And with its single cable USB-C connection, the DTEN device not only streamlines your connectivity but also provides dependable power to your laptop, eliminating any worries about losing power during critical moments.

Stay productive and connected with DTEN's all-in-one collaboration solution and enjoy the freedom to collaborate in any meeting room.



USB-C





## Use Case 2

Not only can you use DTEN's camera, microphone, speaker, and touch features during your meetings, but you can also leverage these features to enhance your experience with other applications on your laptop. For instance, when using a whiteboard application, drawing with a mouse can be challenging, but with DTEN's touch device, you can effortlessly draw with precision and control your laptop's display using DTEN's touch panel.

With its single cable USB-C connection, the DTEN device also provides reliable power to your laptop, ensuring that you never have to worry about losing power during critical moments. Enjoy seamless connectivity and uninterrupted productivity with DTEN's all-in-one collaboration solution.

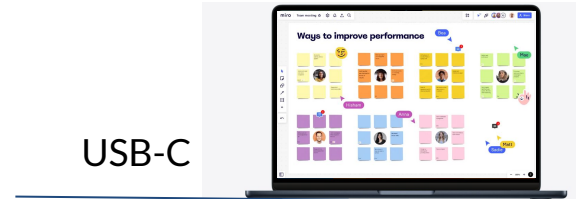
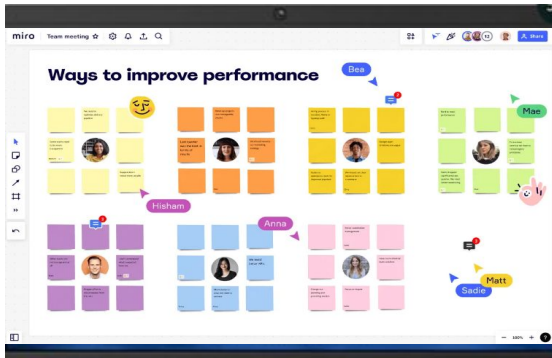

USB-C





# System I/O Connections

## D7X Windows

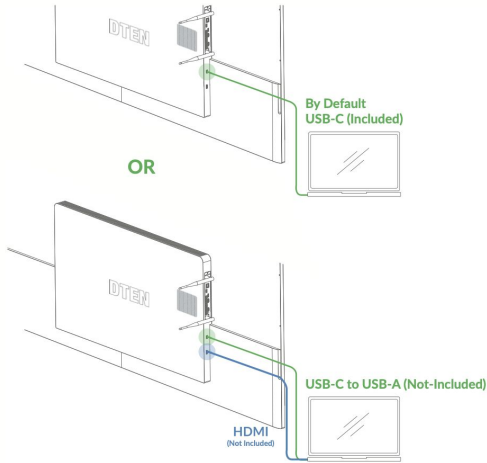

## D7X Android

Access the DTEN D7X camera system, microphone array, speakers and touchscreen as peripherals from an attached computer

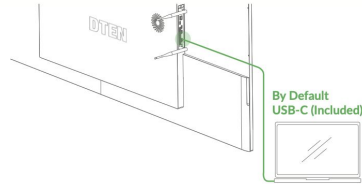

## DTEN GO

Using the DTEN GO as your computer's camera and microphone array (DTEN Smart Connect)

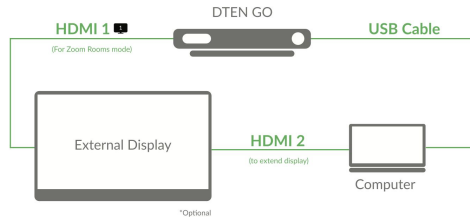

## DTEN ME Pro

You can utilize DTEN ME's touch speakers, camera and microphone arrays as your computer's peripherals.

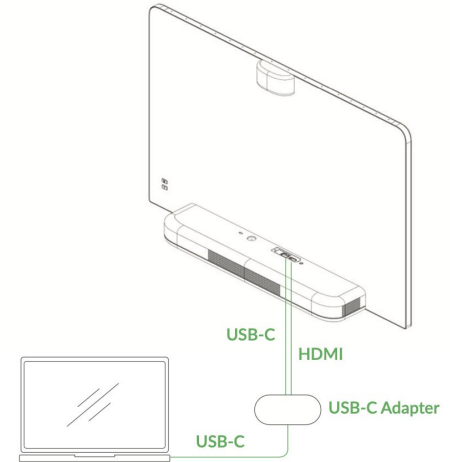



# DTEN Systems Support Smart Connect (BYOD)

Updated 20240604

Product	Via USB-C (For Thunderbolt port laptop )	Via HDMI+USB-A/USB-C (For Non-Thunderbolt port laptop )
D7X Windows	Yes (Cam/mic/speaker/touch/power)	Yes (Cam/mic/speaker/touch)
D7X Android	Yes (Cam/mic/speaker/touch/power)	TBD in an upcoming release
Bar	Yes (Cam/mic/speaker/touch/power)	TBD in an upcoming release
D7 G1 / G2	No	No
ME	No	No
ME Pro	No	Yes (Smart connect:Cam/mic/speaker/Touch)
GO	Yes (Smart connect:Cam/mic/speaker)	No
ON	No	No





The experience on each platform







# BYOD Setting on ZDM

\* Content or schedule may change without notice | DTEN Internal ONLY

## Disable Prompt

To avoid seeing the BYOD connection prompt every time you plug in the USB-C cable, please disable this BYOD Connection Prompt feature in ZDM.

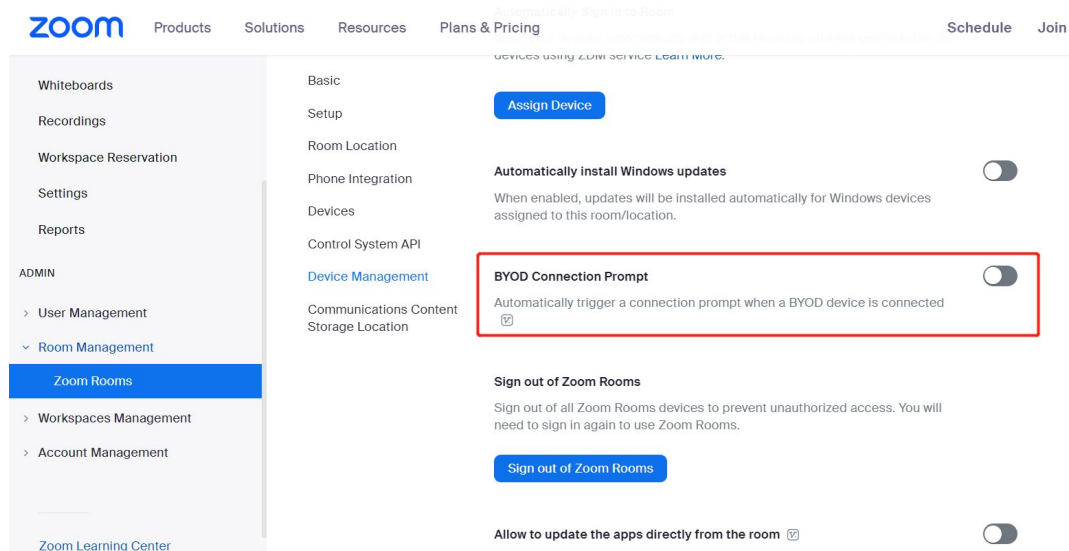

The screenshot shows the Zoom Admin console interface. The left sidebar contains navigation options: Whiteboards, Recordings, Workspace Reservation, Settings, Reports, ADMIN, User Management, Room Management, Zoom Rooms (highlighted), Workspaces Management, and Account Management. The main content area is titled 'Zoom Rooms' and includes a 'Basic' section with an 'Assign Device' button. Below this, there are several settings: 'Automatically install Windows updates' (disabled), 'BYOD Connection Prompt' (disabled and highlighted with a red box), 'Sign out of Zoom Rooms' (with a 'Sign out of Zoom Rooms' button), and 'Allow to update the apps directly from the room' (disabled).





# D7X Windows Smart Connect BYOD

Plug in HDMI in / USB-C, and select BYOD Mode

Entering BYOD mode...

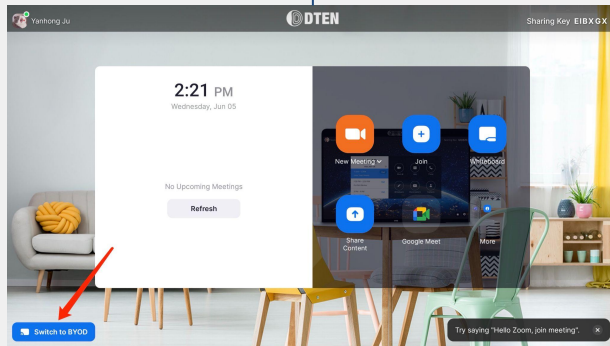
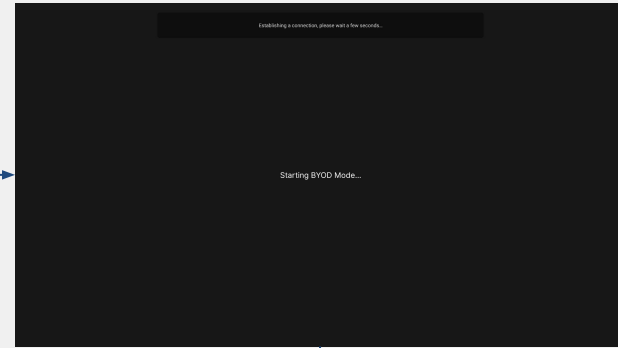
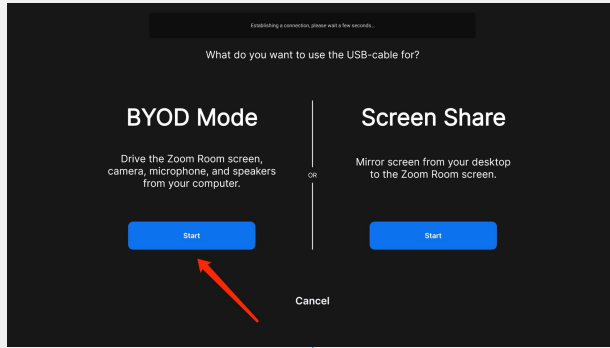

If you exit BYOD mode with the cable plugged in, there will be a button to enter BYOD mode in the lower left corner of the Zoom Rooms homepage, and you can re-enter BYOD mode by clicking it.



# D7X Windows Smart Connect BYOD cont'd



## Camera Control in BYOD mode

1. Press the Menu button on the back of the DTEN device to open the DTEN Dashboard.
2. Tap Settings, then select Camera Control for Smart Connect Mode under "Camera Settings" section.
3. Adjust the camera positions as needed.

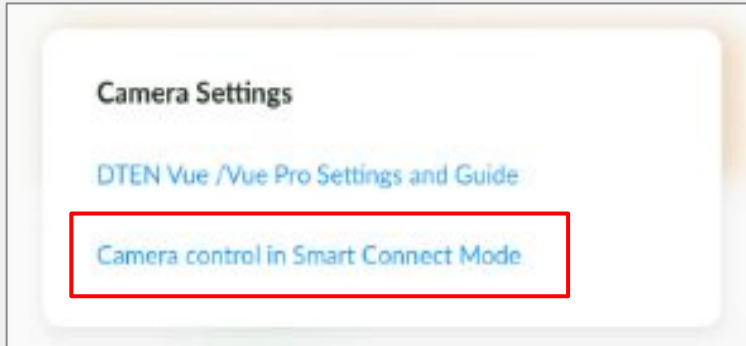

**\* It's only available on D7X Windows**

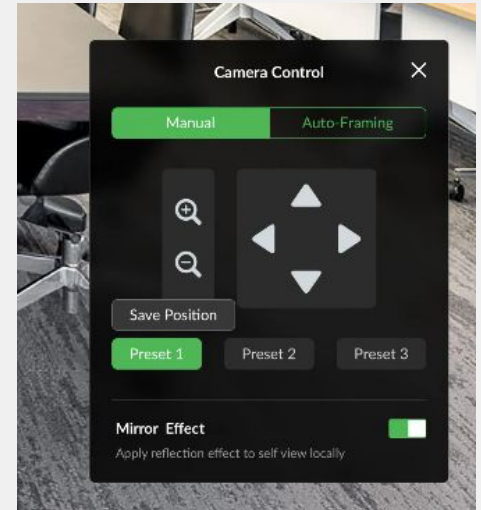



# D7X Android Smart Connect BYOD

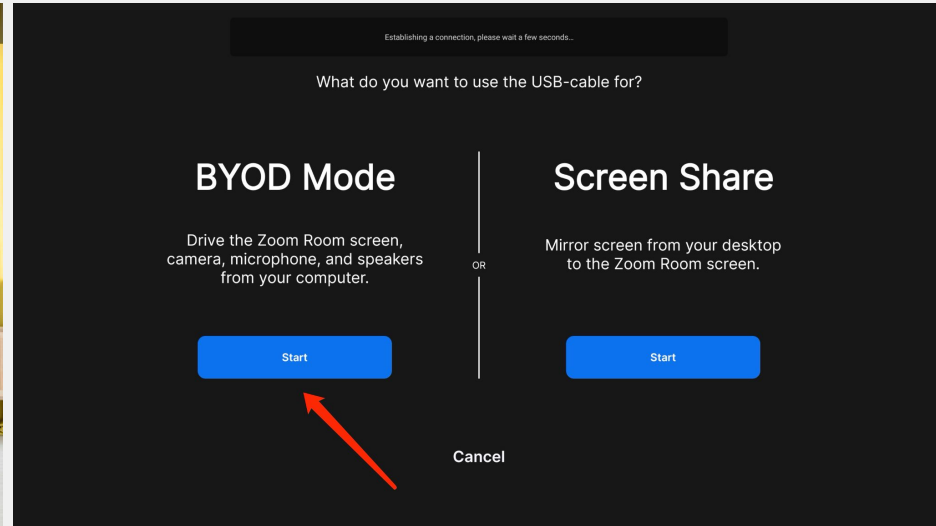
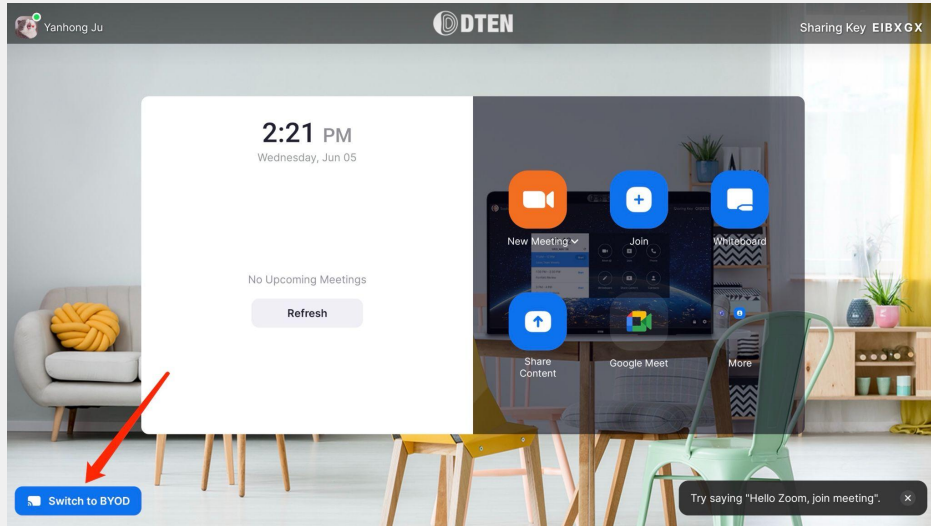



# DTEN Bar Smart Connect BYOD



PRODUCT MATERIAL | DTEN INTERNAL ONLY

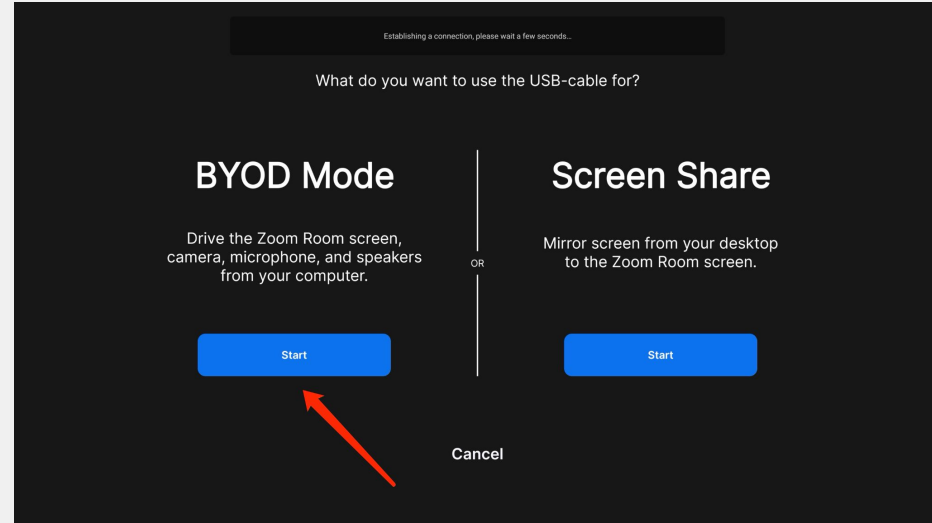
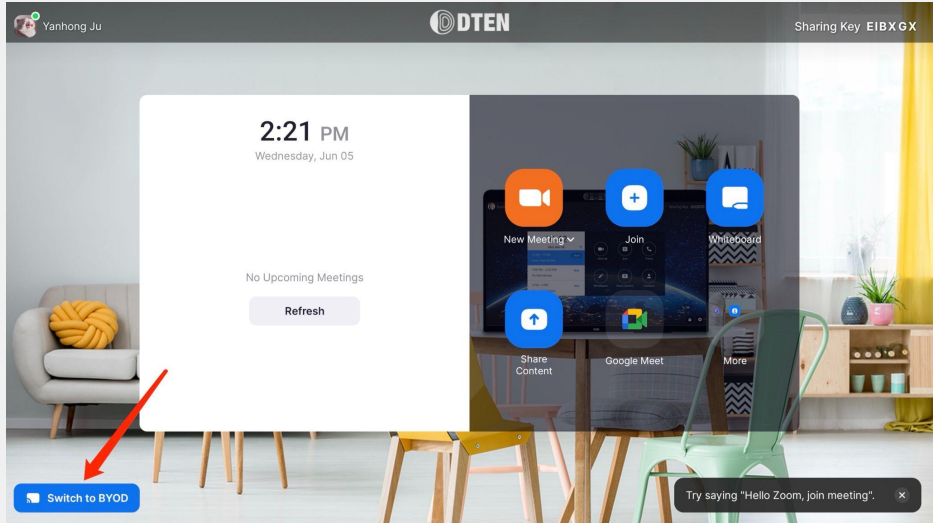



# DTEN ME Pro Smart Connect



PRODUCT MATERIAL | DTEN INTERNAL ONLY

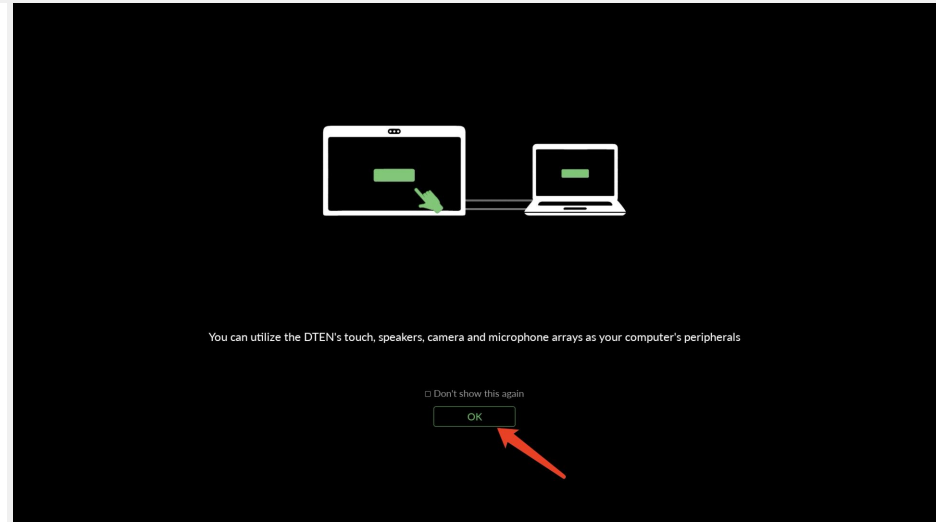
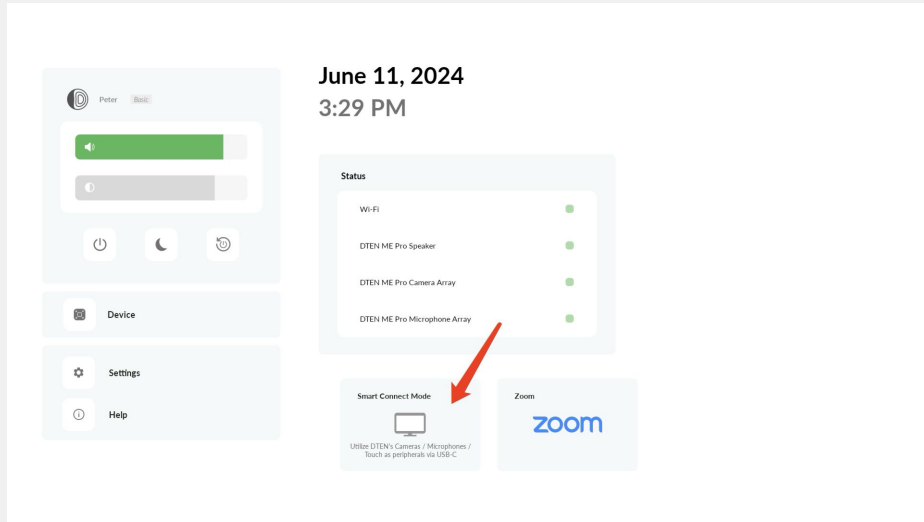



# DTEN GO Smart Connect



PRODUCT MATERIAL | DTEN INTERNAL ONLY

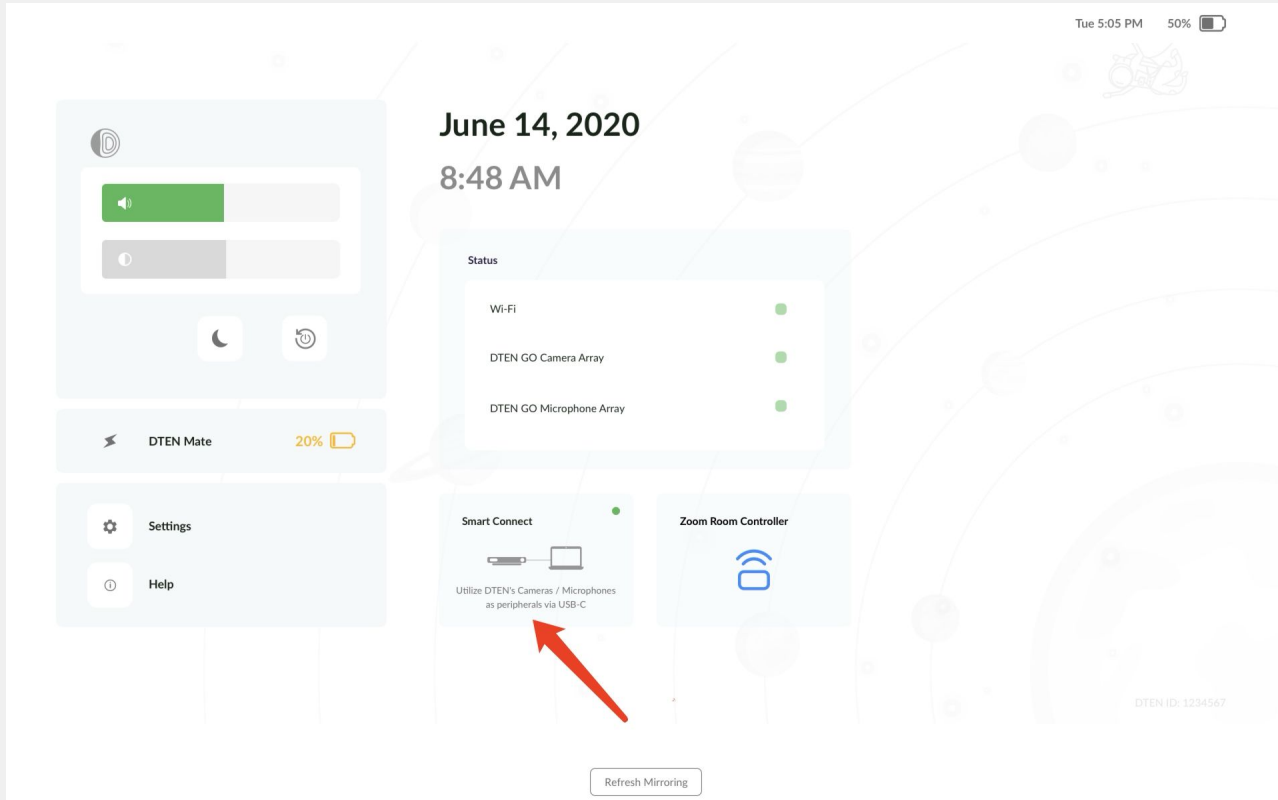



# D7X Android Smart Connect BYOD

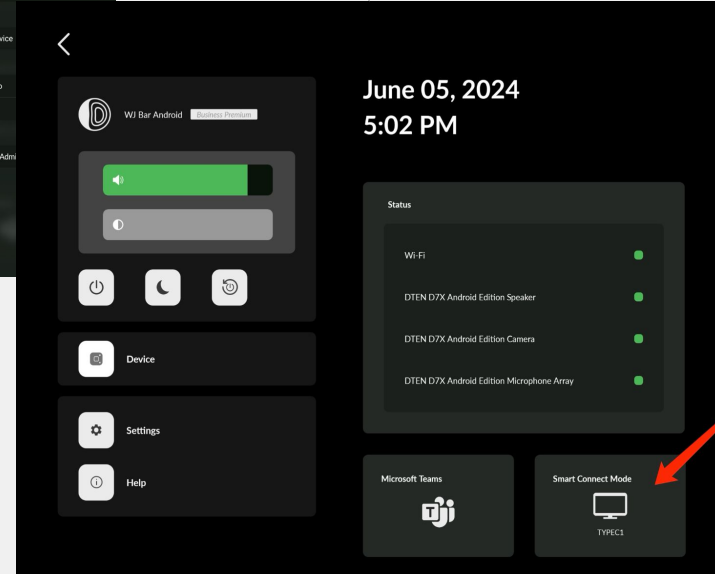
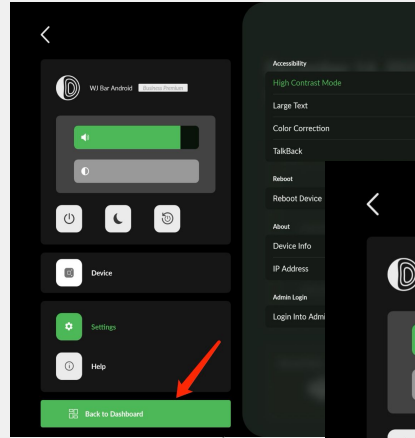
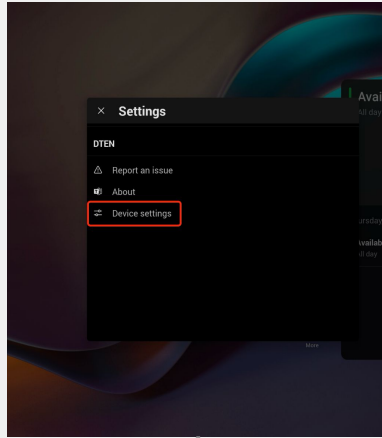
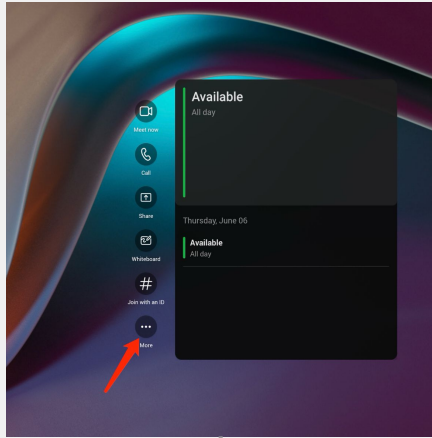





# DTEN Bar Smart Connect BYOD

PRODUCT MATERIAL | DTEN INTERNAL ONLY

**BYOD mode can be accessed from the paired Mate Menu.**

Version: DTEN Bar v1.2.6 and above

DTEN Mate v2.2.6 and above

**Under Admin Settings > Change input Source**

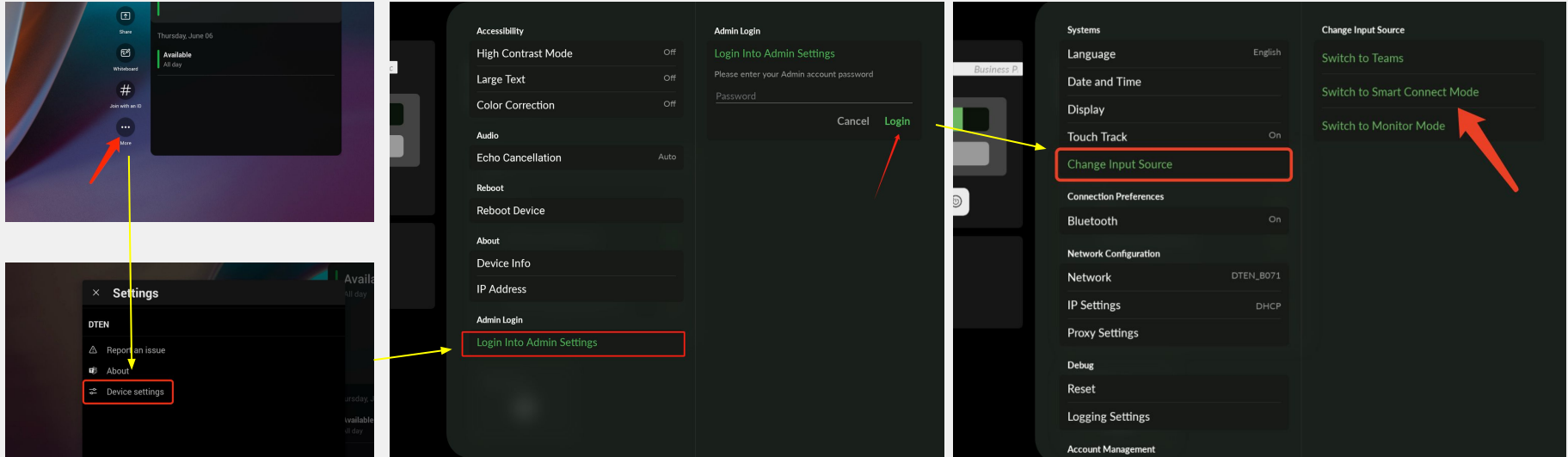

# Q&A

**1. What should I do if my laptop does not support usb-c?**

You could use the USB-A and HDMI connecting the DTEN device with laptop .It's a another way to use BYOD

**2. I use the USB-C for content share, but it does not work.**

Please check your computer spec if the USB-C port support Displayport Alt mode. The USB-C content share required the laptop to support Displayport Alt mode. Otherwise please use HDMI In for content share.

**3. Can I use BYOD without a Zoom Room license or I didn't sign in the Zoom account? And how do I use it?**

You can still use BYOD even if you don't have a Zoom Room license. To connect your PC to the DTEN device, press the Menu Hard Key located in the back corner of the DTEN device, then select the Smart Connect button. This will give you access to smart connect mode(which is the same feature as BYOD).

**4. It takes many steps to get to BYOD on the Bar, why? *Internal reference do not post***

Microsoft's definition of BYOD is different and MS is still defining what is MS BYOD. Currently, plug-n-play BYOD does not exist in MTR. Being able to allow our customers to still access Smart Connect is beyond-ready. We are exploring experience improvement *under MS limitations and constraints* In a later release, we may relocate the access to hot-swap pop-up or a button, but for now, the current access point is the set. We shall handle customer needs case-by-case and guide them to the admin settings menu.

**5. Is there a longer USB-C cable I can use? *Internal reference do not post***

MS recommended [a solution](#) and it is compatible with all DTEN products (though it is not guaranteed compatible with your laptops, check with vendor).

